

## Demension

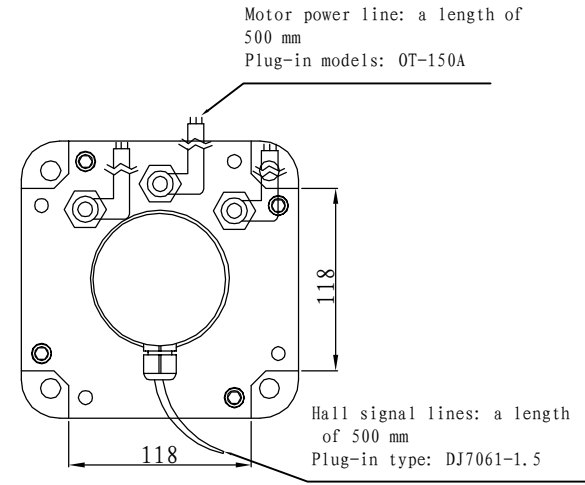

## Motor to Hall Relationship

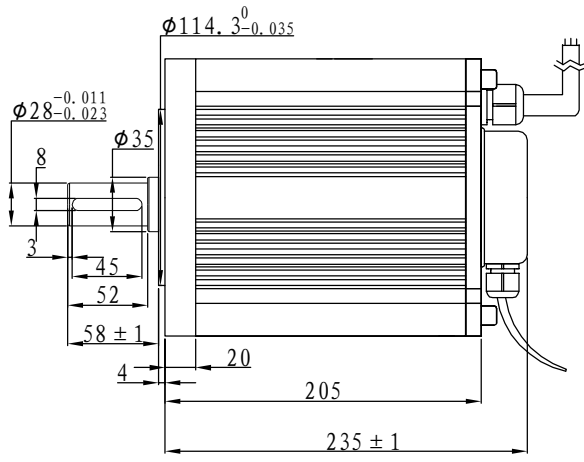
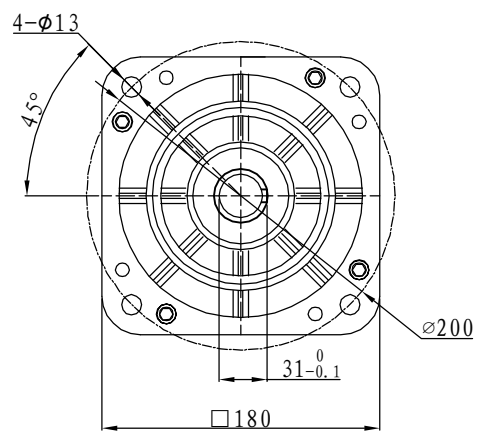
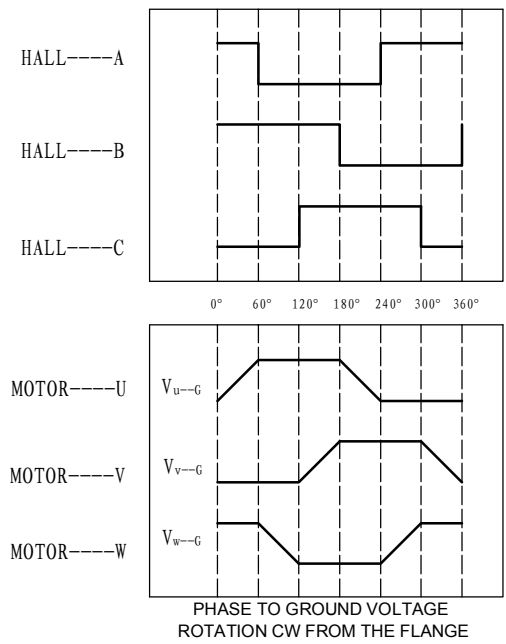

## Line Define

Power Wire	
Red	Motor U
Yellow	Motor V
Blue	Motor W

## Feedback Wire

Hall line colour	Hall signal definition	Plug serial number
Orange and black	5V	1
Orange	0V	2
Yellow	Hall A	4
Blue	Hall B	5
Green	Hall C	6

## Tecnichal Data

Type	180WD-M16030-72V
Power (KW)	5.0
Rated voltage (V)	72
Rated current (A)	82
Rated speed (rpm)	3000
Rated torque (NM)	16
Rotor inertia (Kgcm <sup>2</sup> )	55
Protection rank	IP65
Insulation rank	F
Appropriate environment	Temperature: 0~50°C Humidity: <90% (No dewdrop)
Motor weight (KG)	18.6